

USB + PS/2 Console KVM Switch UCNV-104D / UCNV-184D / UCNV-108D / UCNV-116D



Available colors:

Cables

1-to-3 Cable for PS/2 Computer CBM-180H	1-to-2 cable for USB Computer CBM-180UH
PS/2 Y-Adapter	

Features

- Cascade configuration expands system capability
- 1U-height form factor saves rack spaces
- Unique cables for secured connection
- Auto-scan function automatically selects computer sequentially
- Assigns computers with individual names
- Identifies and selects computers by chosen names
- Programmable scan filters unused computers.
- Password security locks computer from unauthorized access
- Complete control with easy-to-use OSD interface
- Hotkey functions allow easily computer access
- Keyboard states automatically saved and restored while switching computers
- Operating system independent and transparent to all applications
- Plug-n-play system configuration
- DDC2B compatible
- Optional module supports microphones and stereo speakers
- Supports SUN keyboard emulation

The Slim NovaView KVM Switches, UCNV series offer the most reliable and efficient way of managing multiple computers in server rooms where space is at a premium. On Screen Display (OSD) features computer naming, computer selection, status indication, auto scan and much more. Up to 136 servers can be easily managed by cascading multiple KVM switches to expand the capacity. Revolutionized video enhancement technology ensures superb quality of resolutions of up to 1920 x 1440. For secured connections and space saving, all Slim NovaView KVM Switches require just one HDB15 connector for each computer connection.

For USB,PS/2 console selections, UCNV-108D and UCNV-116D are equipped with a slide switch on the rear panel, through which the USB or PS/2 console mode is chosen.

Connection Pattern

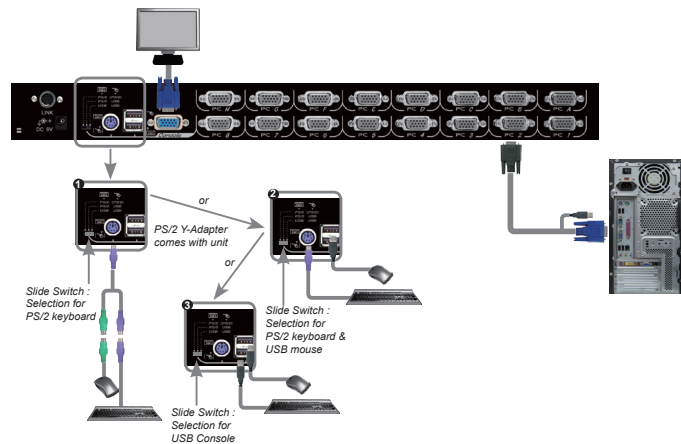

Specifications

		UCNV-104D UCNV-184D	UCNV-108D	UCNV-116D
Number of Console Ports		1		
Number of Computer Ports		4	8	16
Number of Cascade Control PCs		16	64	136
Control Buttons on Front Panel		4	8	8
Applicable to computer		PS/2 PC, USB PC, USB-Sun, USB-Mac		
On-Screen Display (OSD)		Yes		
Plug-n-Play		Yes		
Hotkey Control		Yes		
Computer Name Entry		14-Character		
Auto-Scan Interval		3, 8, 15, 30 Seconds		
Programmable Scan Pattern		Yes		
Security Control		4-Character Password Per Computer		
Cable Type		1-to-3 (PS/2) or 1-to-2 (USB) Cable Max 30M (100ft) at CONSOLE Max 30M (100ft) at PC ports for PS/2 computer Max 5M at PC ports for USB computer		
Video Resolution		1920 x 1440, DDC2B		
Computer Connectors		HDB15 Female (Grey) x 4	HDB15 Female (Grey) x 8	HDB15 Female (Grey) x 16
		for PS/2 + USB Interface		
Console Connectors	Keyboard Mouse Monitor	UCNV-104D	UCNV-184D / UCNV-108D / UCNV-116D	
		USB mouse x 1 USB keyboard x 1 (also for keyboard with mouse) HDB15 monitor female x 1	USB mouse x 1 USB keyboard x 1 (also for keyboard with mouse) Mini-Din connector of Y-adapter x 1 (for PS/2 mouse and PS/2 keyboard) HDB15 monitor female x 1	
Size		1U		
Power Consumption (Max.)		9V DC, 500mA		
Dimensions H x W x D (mm)		(UCNV-104D: 44 x 220 x 130) 44 x 438 x 180		